

GROUND FLOOR DIAGRAM

Revised: Jan 2012



LITTLETON
REGIONAL
HOSPITAL

600 St. Johnsbury Road
Littleton, NH 03561
(603) 444-9000

LRH Audiology
Erin Taylor, MS

SUITE 15

**North Country
Otolaryngology**
Deane E. Rankin, MD
Patrick Fitzpatrick, DO

SUITE 14

**North Country
Gastroenterology**
Howard S. Mitz, DO

SUITE 13

**Eye Associates of
Northern New England**
Stephen S. Phipps, MD
Paul M. Lindstrom, OD
Krista Haight, MD
Brian Mawhinney, OD

SUITE 12

Littleton Internal Medicine
Kevin A. Silva, MD
Rebekah L. Reeves, MD

SUITE 11

**White Mountain Family
Healthcare**
John Spicer, MD
Angela Hawkins, PA-C

SUITE K

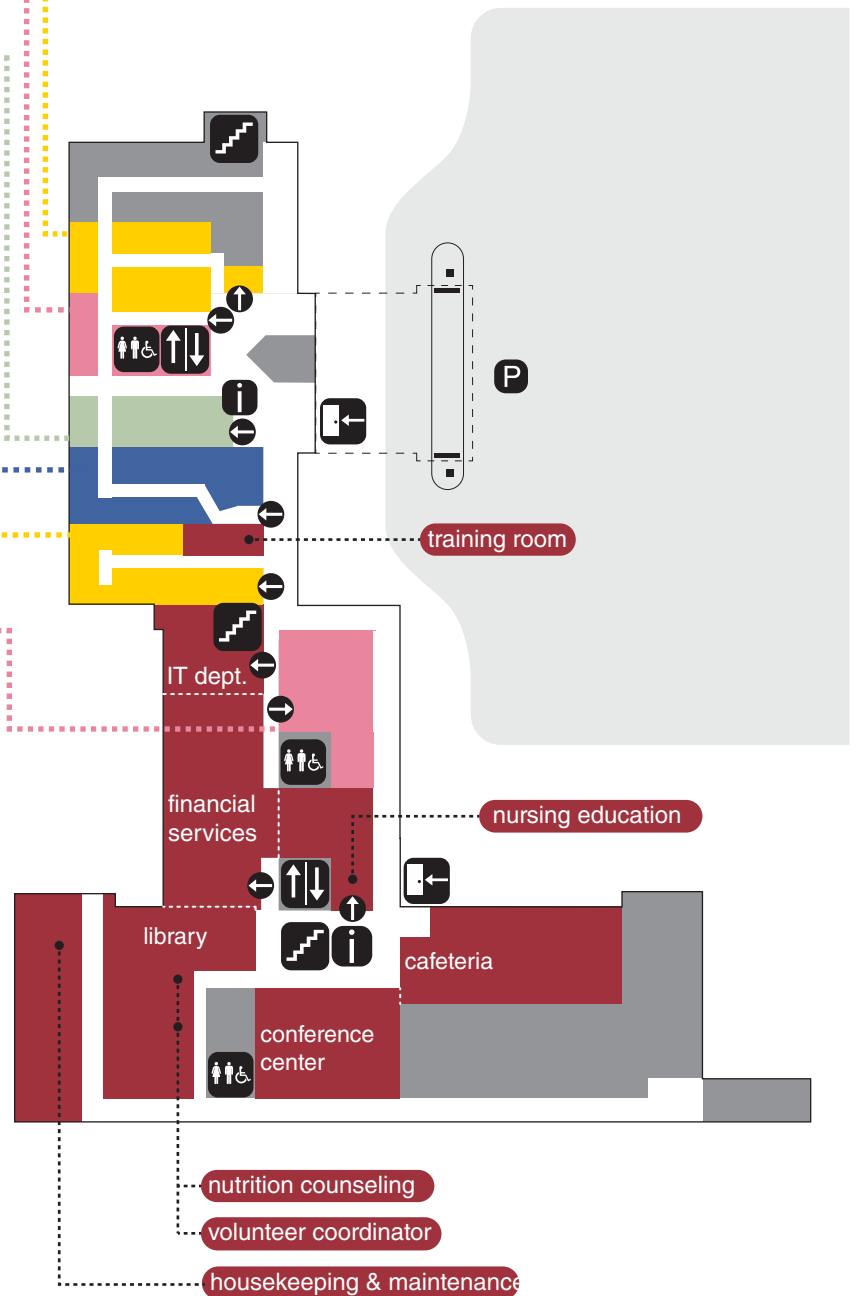

- parking
- information
- department entrance
- building entrance
- elevators
- stairs
- restroom

FIRST FLOOR DIAGRAM

Revised: Jan 2012



600 St. Johnsbury Road
Littleton, NH 03561
(603) 444-9000

North Country Pediatrics
William F. Lakey, MD
Cristina M. Culcea, MD

SUITE 26

Medical & Surgical Specialties
Michael Kindred, MD
Alice F. Rocke, MD
David B. Lovejoy, MD
Gopalan Umashankar, MD

SUITE 22

Hitchcock Clinic / Littleton
Emil Pollak, MD

SUITE A

Podiatry
W. Kemp Schanlaber, DPM
Hal Gooman, DPM
Center for Sleep Medicine
Joseph DellaValla MD

SUITE B

SUITE 25

North Country Internal Medicine
Malgorzata Taras, MD
David V. Ferris, DO

SUITE 21

North Country Women's Health
Nicholas Marks, MD
Emily Kelly, APRN, IBCLC

SUITE C

Summit Medical Group
Kathleen Smith, MD
Virginia Alvord, MD
Patricia Kellogg P-AC

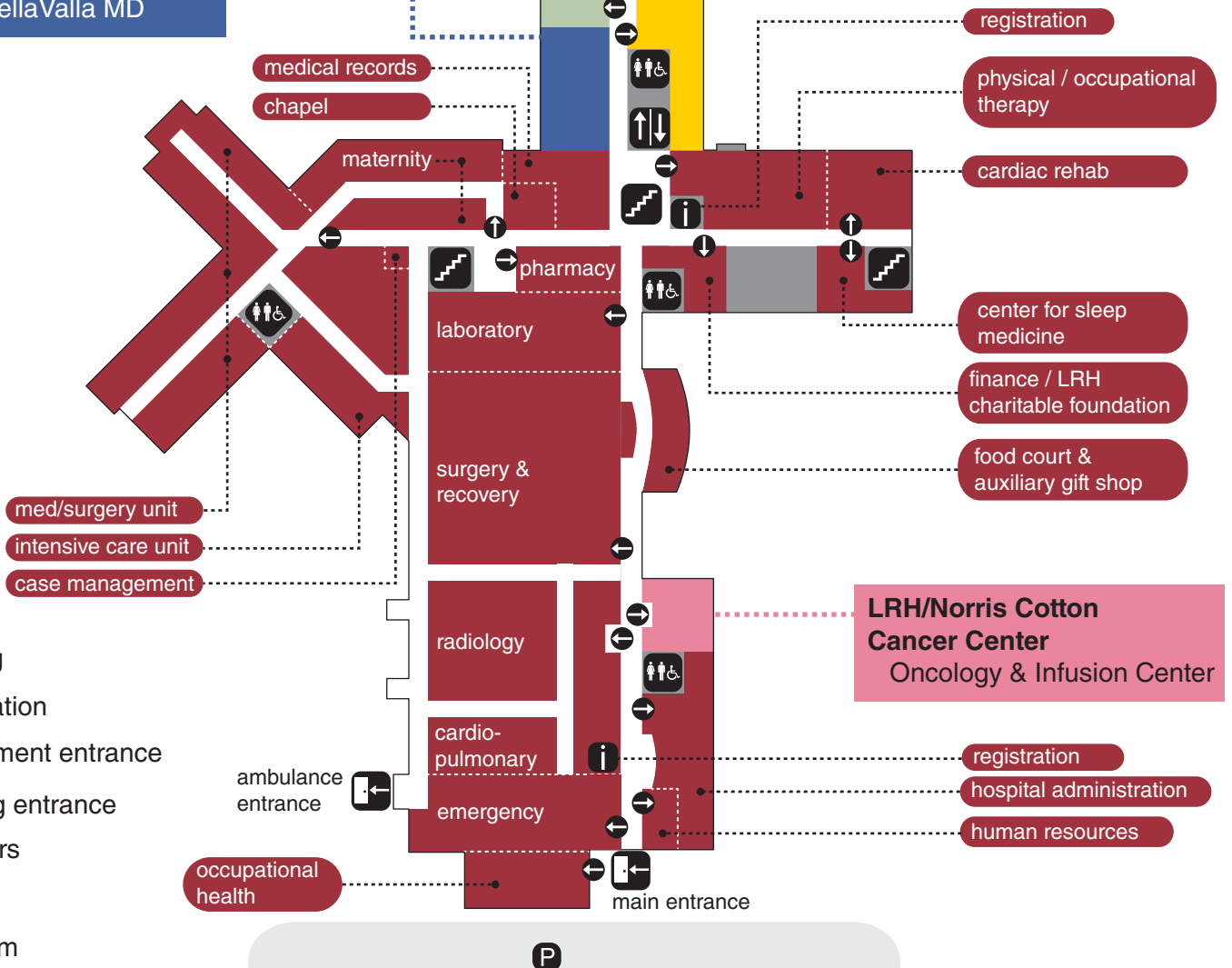

- parking
- information
- department entrance
- building entrance
- elevators
- stairs
- restroom



PRACTITIONER DIRECTORY

Practitioner's Name	Floor & Direction	Suite	Practice Name
Virginia L. Alvord, MD	Level One - Right	C	Summit Medical Group
Cristina M. Culcea, MD, FAAP	Level One - Left	26	North Country Pediatrics
Joseph P. DellaValla, MD	Level One - Right	B	Center for Sleep Medicine at Littleton Regional Hospital
David V. Ferris, DO	Level One - Left	25	North Country Internal Medicine
Andrew Forrest, MD	Level One - Right	22	Physical Medicine and Rehabilitation
Hal B. Goolman, DPM	Level One - Right	B	Podiatry Services and Foot & Ankle Medicine Surgery
Pat Kellogg, PA-C	Level One - Right	C	Summit Medical Group
Emily Kelly, APRN, IBCLC	Level One - Right	21	North Country Women's Health
Michael Kindred, MD	Level One - Right	22	Surgical Specialties
William E. Lakey, MD, FAAP	Level One - Left	26	North Country Pediatrics
David B. Lovejoy, MD	Level One - Right	22	North Country Orthopedics
Nicholas Marks, MD, FACOG	Level One - Right	21	North Country Women's Health
Emil M. Pollak, Jr., MD, FACC	Level One - Right	A	Hitchcock Clinic Littleton
Alice F. Roche, MD	Level One - Right	22	Surgical Specialities
W. Kemp Schanlaber, DPM, MS	Level One - Right	B	Podiatry Services and Foot & Ankle Medicine Surgery
Kathleen Smith MD, FAAFP	Level One - Right	C	Summit Medical Group
Malgorzata Taras, MD, MPH	Level One - Left	25	North Country Internal Medicine
Gopalan Umashankar, MD	Level One - Right	22	Neurology Associates
Richard E. Caesar, MD	Level One - Right	22	Urology Associates
Patrick Fitzpatrick, DO	Ground Level - Left	14	North Country Otolaryngology
Kritsa N. Haight, MD	Ground Level - Right	12	Eye Associates of Northern New England Paul M. John
Angela Hawkins, MD	Ground Level - Left	K	White Mountain Family Healthcare
Marvin Kendall, MD	Ground Level - Left	K	White Mountain Family Healthcare
Lindstrom, OD	Ground Level - Right	12	Eye Associates of Northern New England Brian J.
Mawhinney, OD	Ground Level - Right	12	Eye Associates of Northern New England
Howard S. Mitz, DO, FACOI	Ground Level - Right	13	North Country Gastroenterology
Stephen J. Phipps, MD	Ground Level - Right	12	Eye Associates of Northern New England
Deane E. Rankin, MD	Ground Level - Left	14	North Country Otolaryngology
Rebekah L. Reeves, MD	Ground Level - Right	11	Littleton Internal Medicine
Kevin A. Silva, MD, FACP	Ground Level - Right	11	Littleton Internal Medicine
John Spicer, MD	Ground Level - Left	K	White Mountain Family Healthcare
Erin Taylor, MS, CCC-A, F-AAA	Ground Level - Left	15	LRH Audiology
The Optical Shop	Ground Level - Right	12	Eye Associates of Northern New England



Centennial Trail Dedication

In 1896, W.I. Lincoln Adams purchased land known as Hilltop Farm on the same parcel of land where the new Littleton Regional Hospital facility was built in 2000. Mr. Adams was a direct descendant of the Adams' Presidential family of Boston. He is known for taking the first flashlight picture made in 1865.

Mr. Adams, his wife, Grace Wilson Adams, and their five children spent summers in Littleton, NH.

Mr. Adams purchased the estate the year his youngest daughter Carolyn was born. Not one of the five children loved the farm more than Carolyn did or enjoyed life with such intensity. She was a true child of nature possessing an innate appreciation of the beauties of the outdoors. Her tender sympathy with those less fortunate was one of her most notable characteristics. Shortly after her untimely death at the young age of 14, her father found among her belongings the following little poem in her handwriting. There was no mark whereby to tell the authorship. It is assumed to be her own production, and shows the high quality of her thoughts and a child's imagination rich in promise.



"Every night a star high above me
Sends its light clear and bright,
To say I love you.
Sends its light clear and bright,
To say I love you.

In bed I lie but not sleeping.
From afar, calls a star,
My watch I am keeping.
From afar, calls a star,
My watch I am keeping."

It is fitting that Littleton Regional Hospital was built on the very soil where Carolyn lived and loved life.

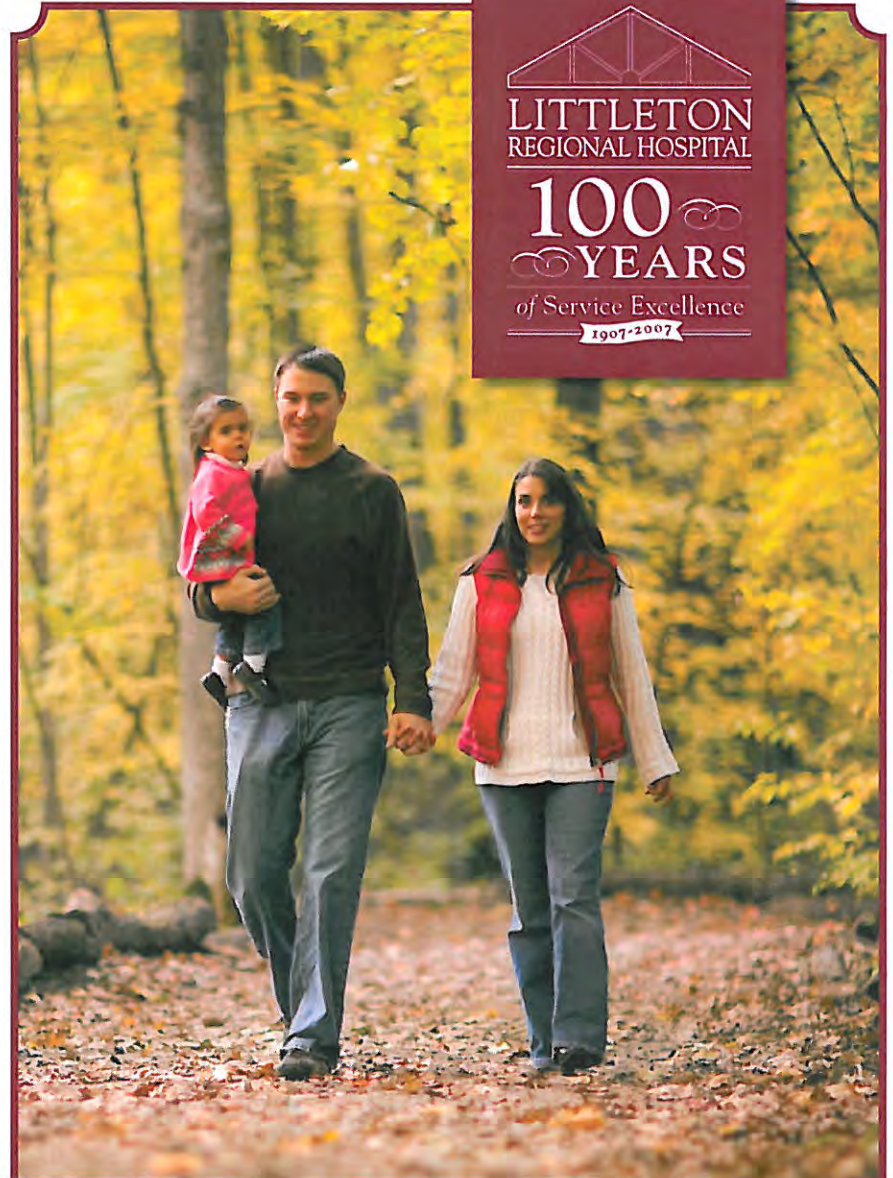
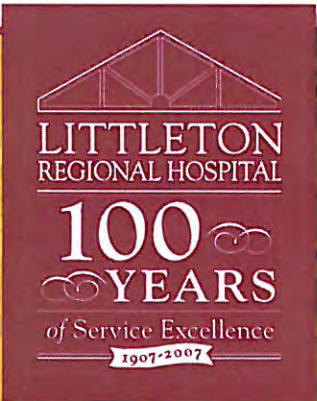
LITTLETON
REGIONAL HOSPITAL
100
YEARS
of Service Excellence
1907-2007



THE W.I. LINCOLN ADAMS FAMILY WALKING TRAIL

DEDICATED ON JUNE 23, 2007



LITTLETON REGIONAL HOSPITAL

THE W. I. LINCOLN ADAMS FAMILY WALKING TRAIL

Legend	
L.R.H. Trail	
Trail Signs	
Viewpoint	
Swampy Area	
Parking Lot	

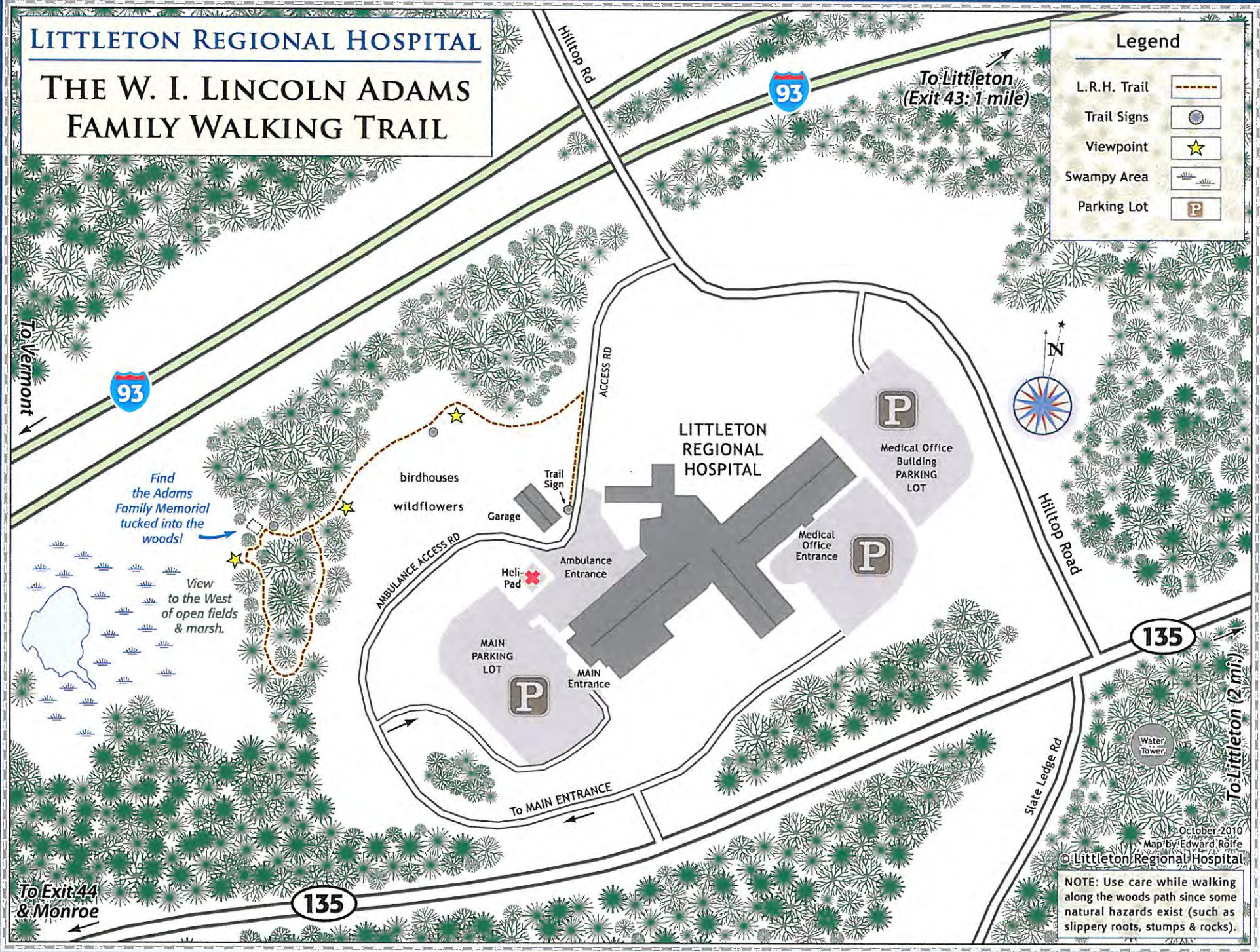

To Vermont

Find the Adams Family Memorial tucked into the woods!

View to the West of open fields & marsh.

birdhouses
wildflowers

Trail Sign

Garage

Heli-Pad

Ambulance Entrance

MAIN PARKING LOT

MAIN Entrance

To MAIN ENTRANCE

LITTLETON REGIONAL HOSPITAL

P

Medical Office Building PARKING LOT

Medical Office Entrance

P



Hilltop Road

135

To Littleton (2 mi)

Slate Ledge Rd

Water Tower

To Exit 44 & Monroe

135

October 2010
Map by Edward Rofie
© Littleton Regional Hospital

NOTE: Use care while walking along the woods path since some natural hazards exist (such as slippery roots, stumps & rocks).