

GROUND FLOOR DIAGRAM

Revised: OCT 2010

LITTLETON
REGIONAL
HOSPITAL

600 St. Johnsbury Road
Littleton, NH 03561
(603) 444-9000

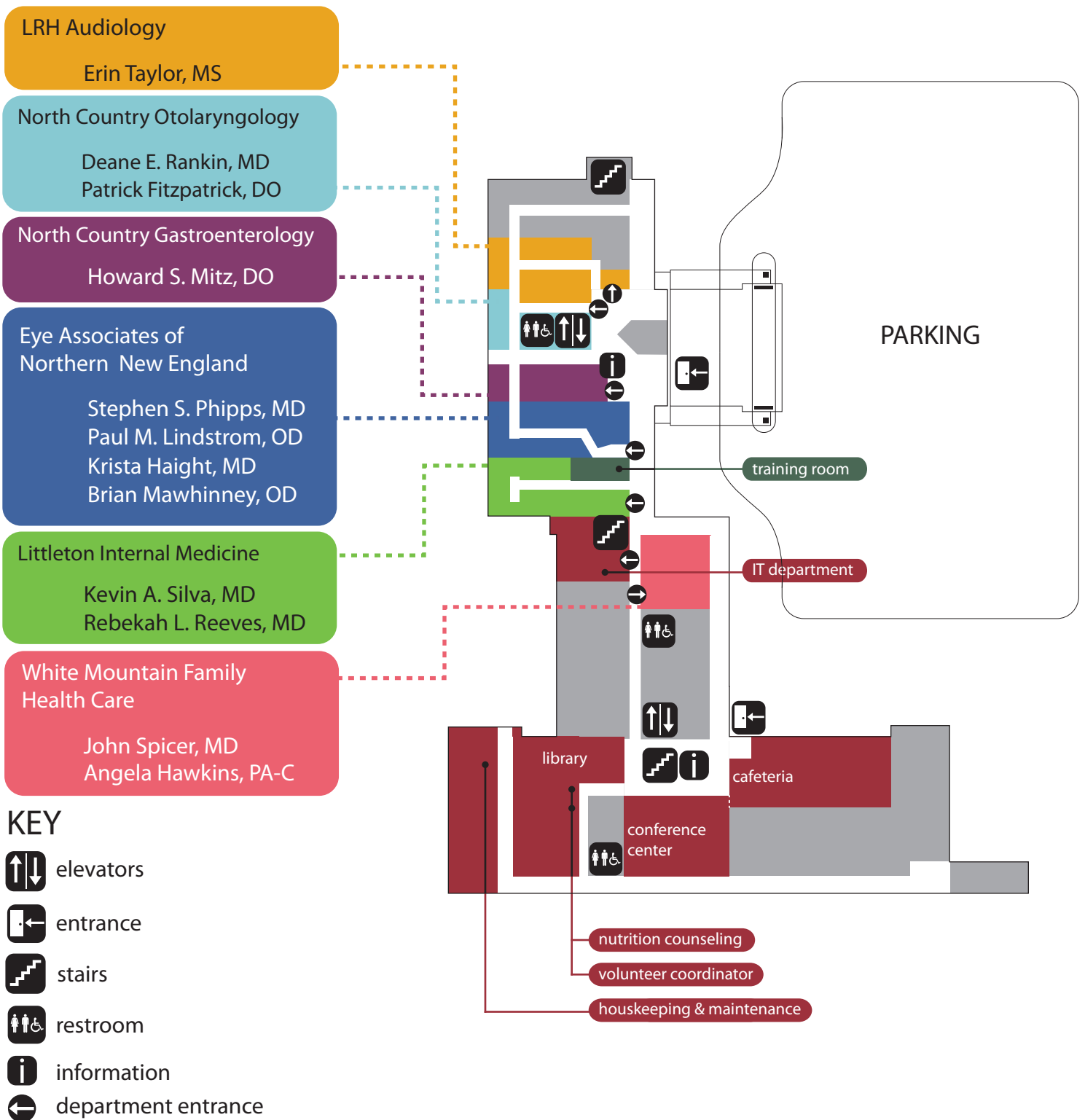

FIRST FLOOR DIAGRAM

Revised: OCT 2010



600 St. Johnsbury Road
Littleton, NH 03561
(603) 444-9000

- North Country Pediatrics**
 William F. Lakey, MD
 Cristina M. Culcea, MD
- North Country Internal Medicine**
 Malgorzata Taras, MD
 David V. Ferris, DO
- Medical and Surgical Specialties**
 Michael Kindred, MD
 Alice F. Rocke, MD
 David B. Lovejoy, MD
 Gopalan Umashankar, MD
- North Country Women's Health**
 Nicholas Marks, MD
 Kathleen Govatski, APRN
 Emily Kelly, APRN
- Hitchcock Clinic / Littleton**
 Emil Pollak, MD
- Dermatology**
 Arthur Daily, MD
- Podiatry**
 W. Kemp Schanlaber, DPM
 Hal Goolman, DPM
- Oncology & Infusion Center**
 Jakow "Jerry" Deiner, MD

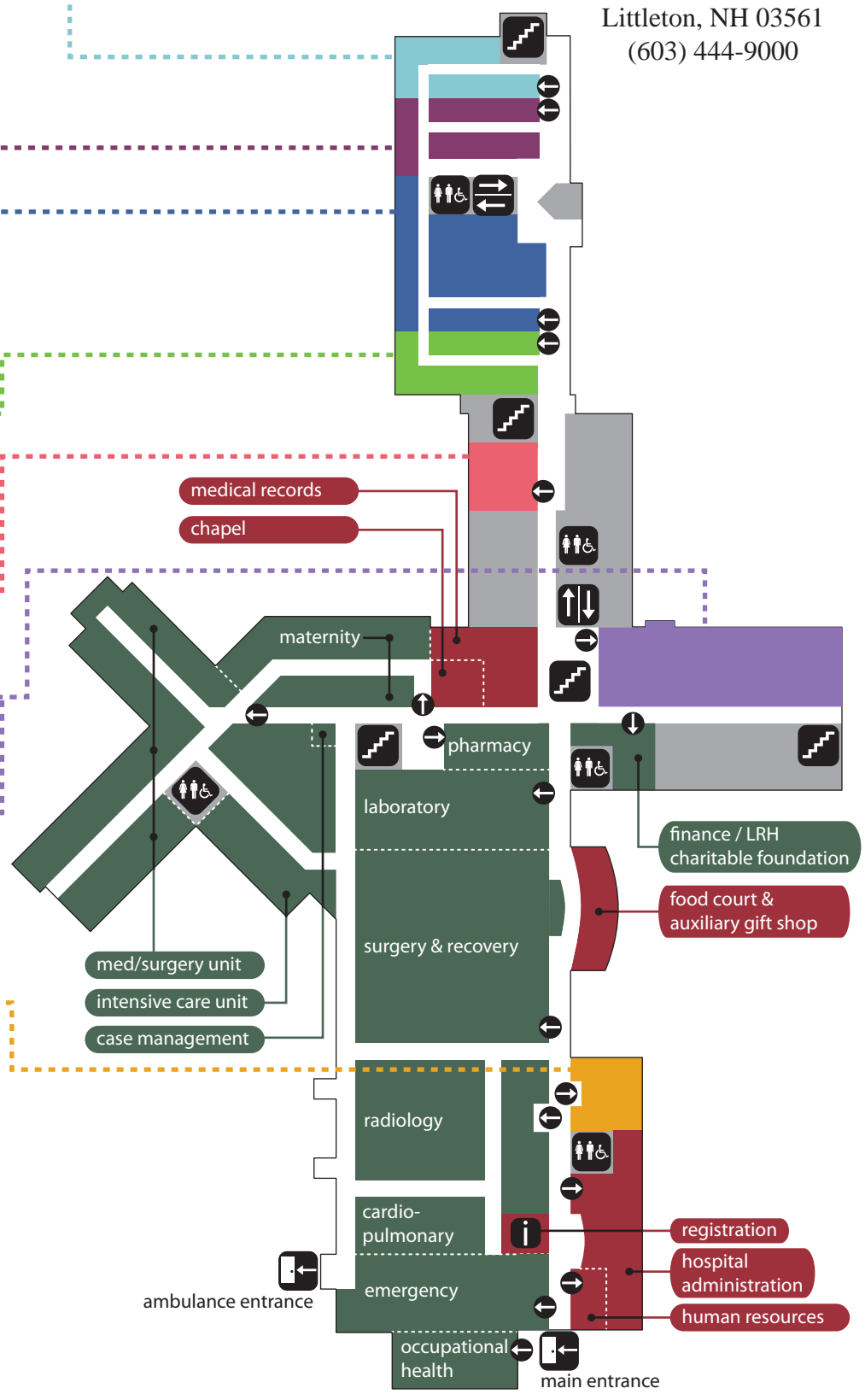

- KEY**
- elevators
 - entrance
 - stairs
 - restroom
 - information
 - department entrance

PARKING